

COATINGS:

FRAMEWORK-COATED PER (ASTM-F-1043) TYPE A
 WELDED FABRIC-NO CUT/NO CLIMB 1/2" x 3" G.A.W.
 OR PVC COATED.

OTHER FABRIC COMBINATIONS AVAILABLE
 FITTINGS-GALVANIZED PER (ASTM-A153)

TOP RAIL=263 LBS @ MID POINT OF 10'-0" SPAN

PHYSICAL PROPERTIES:

DIMENSIONS	WALL THICKNESS	WEIGHT PER FOOT	SECTION MODULUS	YIELD STRENGTH	MAX. BENDING MOMENT LB. IN.
3.25" x 2.50"	0.150"	5.40#	1.25	60,000	75,000
OPTIONAL					
3.25" x 2.50"	0.130"	4.50#	1.083	60,000	64,980

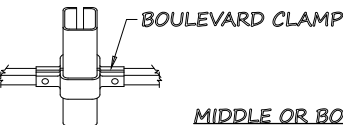

MIDDLE OR BOTTOM RAIL
 CONN. WHEN REQ'D

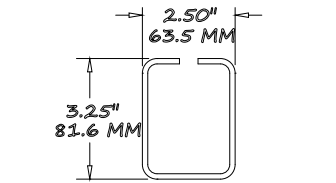
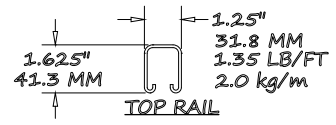
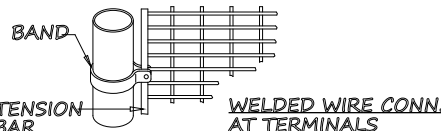
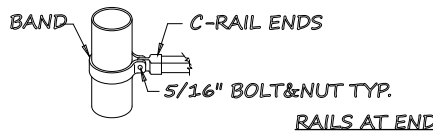
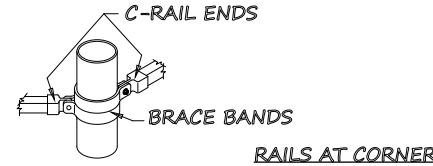
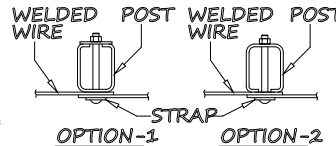

5.30 LB/FT 7.85 kg/m

OPTIONAL 4.40 LB/FT 6.52 kg/m

0.130 WALL

TERMINAL POST

— LBS PER FT.

— INCHES O.D.

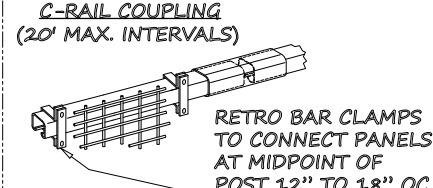
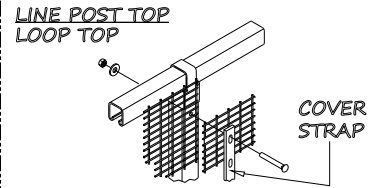
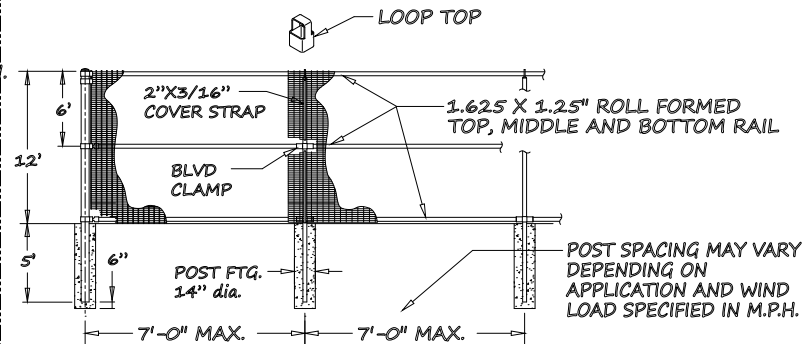

ITEM	QNTY	DESCRIPTION	MATERIAL
SCALE	NONE	CHK'D BY DTM	MACHINING TOLERANCES UNDER 18" ± 0.030 18" AND OVER ± 1/16
DWN BY	DTM08/17/17	APP'D BY	FABRICATION TOLERANCES ± 0.015 ± 0.005 ± 1/4"
SUPER 'C' w/o BARB WIRE, ROUND TERM. (WELDED WIRE)			

CAD FILENAME:
 FENCE 4-7

LAST PLOT DATE:
 08/17/17

GREGORY
 FENCE

4100 13th Street SW
 Canton, Ohio 44710

REF. No.
 DRWG No.

FENCE 4-7