



GREGORY
FENCE

C-POST

GREGORY FENCE FRAMEWORK

“” THE DIFFERENCE





A great fence system starts with the backbone

C-POST

Gregory Fence's unique C-Post features an open "C" design for exceptional strength, easy installation and lasting performance.



Cost-Saving Installation

Installation is simple and cost-effective. C-Post is driven into the ground and self-anchored without the extra time and expense of digging holes or pouring concrete.



Corrosion Protection

Continuously galvanized steel protects both the exterior and interior of the C-Post. Unlike typical round pipes, C-Post's open channel allows increased airflow to prevent rust.



Superior Strength

Ideal for use in high security settings, C-Post begins with a 50,000-pound minimum yield strength steel and outlasts traditional fence posts over time.



MADE IN THE USA

All Gregory Fence products meet Buy America requirements.

“ ” THE DIFFERENCE

Greater Strength – Corrosion Protection
Open Channel Design – Easy Installation

As the backbone of your fence framework, C-Post is known for its superior strength and easy installation.



STANDARD C-POST

1.625" (41.3 mm) W
1.875" (47.6 mm) H
2.4 lbs. (3.75 kg/m)



HEAVY C-POST

1.7" (43.2 mm) W
2.25" (57.1 mm) H
2.78 lbs. (4.14 kg/m)



SUPER C-POST

.130 Wall Thickness
3.25" (82.55 mm) W
2.25" (63.5 mm) H
4.50 lbs. (6.7 kg/m)

WIND LOAD COMPARISON CHART

C-Posts provide greater protection against wind loads

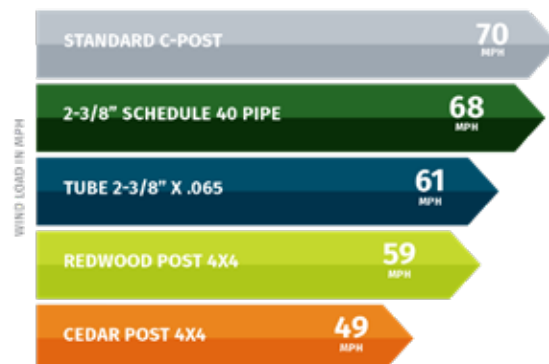

Available Materials

Standard Galvanized High Strength Steel

Our roll-formed, American-made steel products are continuously galvanized for superior quality, durability and handling.

PVC Coating Available

C-Posts can be PVC-coated inside and out for maximum durability and lasting performance in all weather conditions.

C-Post Physical Properties

The chart below is based on the minimum yield strength of each section where the beam loads are theoretical. The actual performance of a given post, either pipe or roll-formed may vary.

	LINE POSTS	OUTSIDE DIM. W X H	MATERIAL THICKNESS	LBS. PER. FT.	SECTION MODULES	MIN. YIELD STRENGTH	BEAM LOAD*
C-POST PHYSICAL PROPERTIES	Super C (.150) 4" O.D. Sch. 40	3.25" X 2.5" --	.150 .226	5.40 9.11	1.260 2.394	60,000 30,000	1050* 998
	Super C (.150) 3" O.D. Sch. 40	3.25" X 2.5" --	.130 .203	4.50 5.79	1.083 1.064	60,000 30,000	902* 443
	HEAVY C 2.5" O.D. SCH. 40	2.25" X 1.70" 2.375"	.121 .154	2.78 3.65	.506 .5606	50,000 30,000	351* 234
	STANDARD C 2.5" O.D. SCH. 40	1.875" X 1.625" 2.375"	.121 .154	2.40 3.65	.395 .5606	50,000 30,000	274* 234
	THINWALL C 2" O.D. SCH. 40	1.875" X 1.625" 1.90"	.105 .145	1.85 2.72	.360 .3262	50,000 30,000	250* 136
	C-TOP RAIL 1.625" O.D. SCH. 40	1.625" X 1.25" 1.66"	.080 .140	1.35 2.27	.158 .235	50,000 30,000	263* 98

* Critical axis perpendicular to fence line

** Theoretical beam loads were computed as follows: Yield strength X section modulus divided by the height in inches (cantilever beam load 72")

*** Yield strength X section modulus X 4 divided* by length in inches (simple beam load 120")

For AUTO CAD drawings or architectural and engineering specifications, visit our website.

General Fence Fittings

Gregory Fence provides a variety of fence fittings made with the strength of steel. Fittings come in standard galvanized steel or custom PVC coating.

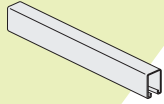

Top Rail Bracing

Roll-formed steel in 1.626" x 1.25" sections with 50,000-lb. minimum yield strength steel. Meets ASTM-F1043 standards.



Rail Sleeve

Easily connect two lengths of C Top Rail together to make one continuous span of C Top Rail, for extra strength.

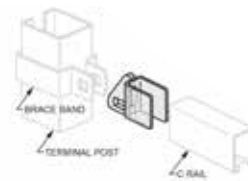

Rail End

Connects with the C-Post framework at the top, middle or bottom rail, using brace bands and bolts.

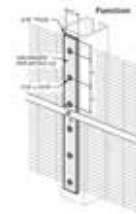

Cover Straps

Used to expand welded wire panel projects, cover straps are available in 8 ft., 10 ft. or 12 ft. lengths.

Standard C, Heavy C & Super C Fence Fittings



Loop Top

A loop top fits securely on the C-Post to provide a loop for either the C Top Rail or the tension wire to pass through.



Barb Arm

Barb arms are a loop cap welded to a 45° arm, notched for 3 strands of barbed wire. Available in single arm or V-arm.

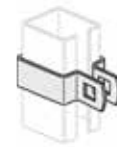

Brace Band

Fits around C-Posts at the end of a rail and accepts a brace rail or truss rod. Braces are available centered or offset.

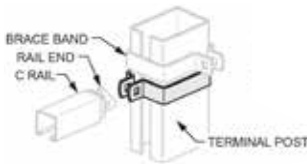

Tension Band

Allows the Super C-Post to act as a corner/terminal post at 90°. Accepts a brace rail, truss rod or barbed wire.

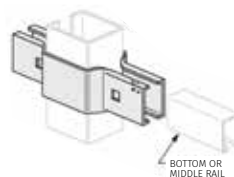

Boulevard Clamp

Connects the middle or bottom rail to the C-Post, with two pieces that fit securely around the C-Post.



Panel Clamps

This two-piece rail set attaches to welded wire and Heavy C projects, in lieu of tie wires for superior strength.

Wood Fence Fittings

Completely cover your fence boards for an all-wood appearance supported by the strength and durability of steel.

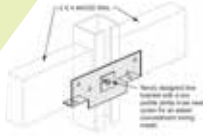

Line Bracket

For use along the length of the fence for extra support.

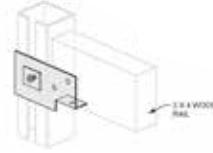

End Bracket

Used to create clean lines at the end of a fence.

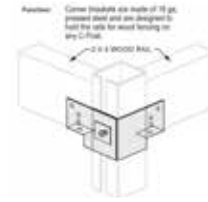

Corner Bracket

Used in 90° turns on the interior or exterior of a fence.

Gregory Fence Accessories Parts List

PART NAME	PART #	SIZE/DESCRIPTION
TOP RAIL BRACING	TR42000	20'
	TR42400	24'
	TR40608	6' 8"
RAIL SLEEVE	CRS	7"
	RAIL END	OREII
BREII		2-HOLE
COVER STRAP	CSHDG8	8'
	CSHDG10	10'
	CSHDG12	12'
LINE BRACKET	LINBKT-THP	WOOD FENCE BRACKET (LINE)
END BRACKET	ENDBKT-THP (R)	WOOD FENCE END BRACKET (RIGHT)
	ENDBKT-THP (L)	WOOD FENCE END BRACKET (LEFT)
CORNER BRACKET	CRNBKT-THP (R)	WOOD FENCE CORNER BRACKET (RIGHT)
	CRNBKT-THP (L)	WOOD FENCE CORNER BRACKET (LEFT)
LOOP TOP	LT5C	FOR STANDARD 'C'

PART NAME	PART #	SIZE/DESCRIPTION
LOOP TOP <small>(CONTINUED)</small>	LT6C	FOR HEAVY 'C'
	LT7C	FOR SUPER 'C'
	BARB ARM <small>(3-STRAND)</small>	BA5C43
BA6C43		FOR HEAVY 'C'
BA7C43		FOR SUPER 'C'
BRACE BAND	EB5C	FOR STANDARD 'C'
	EB6C	FOR HEAVY 'C'
	EB7C	FOR SUPER 'C'
TENSION BAND	TB7C	FOR SUPER 'C'
BOULEVARD CLAMP	LRC5C	FOR STANDARD 'C'
	LRC6C	FOR HEAVY 'C'
	LRC7C	FOR SUPER 'C'
PANEL CLAMP	RMSFC1625	RAIL TO PANEL CLAMP
	RMSFC1625 FLAT	PANEL TO PANEL CLAMP
	RMSFC1700	PANEL TO POST, HEAVY C
	RMSFC2500	PANEL TO POST, SUPER C



4100 13th St. SW, Canton, OH 44710 1-866-GO-CPOST



gregoryfence.com